

CORRECT

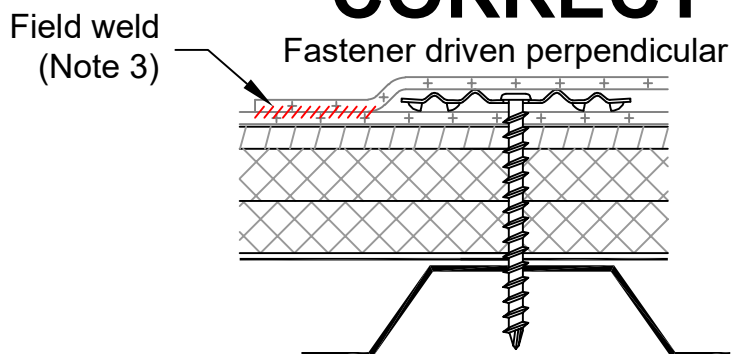

INCORRECT

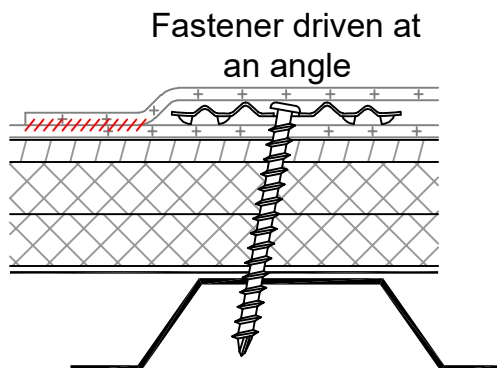
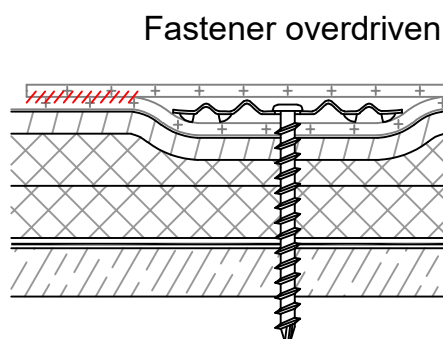
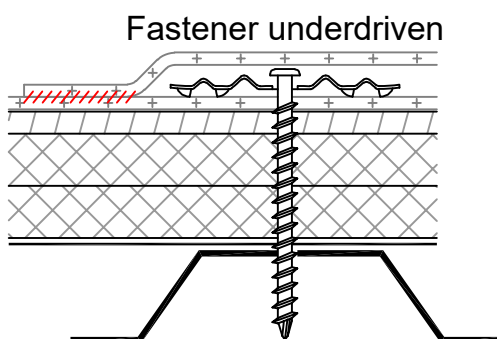
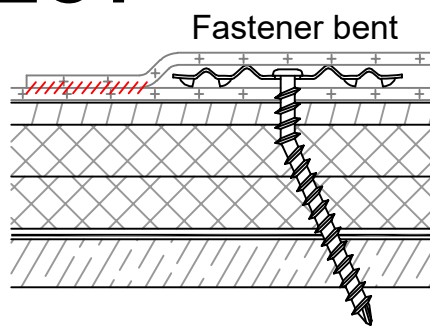
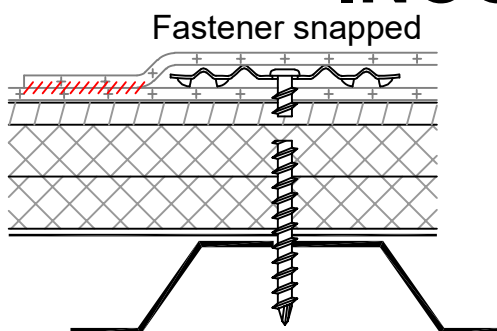

Note 1: Fasteners may penetrate through the top or bottom flute of metal decks.

Note 2: Fasteners must penetrate metal, wood and structural concrete decks by 1 in. (25 mm), measuring down from the top of the deck.

Note 3: All field welds must be a minimum of 1-1/2 in. (40 mm) wide.

REVISED: N/A

TPO GENERAL DETAIL FOR MECHANICALLY FASTENED SYSTEMS

PREVIOUS: 02/11/2025

FASTENING INTO METAL AND WOOD DECKS

SCALE: NONE

NEW CONSTRUCTION OR RE-ROOF