

Fasten 6 in. (152 mm) on center with 1-1/4 in. (32 mm) roofing nails. Decrease fastener spacing to 3 in. (76 mm) on center at outer corners of roof 10 ft (3 m) min.

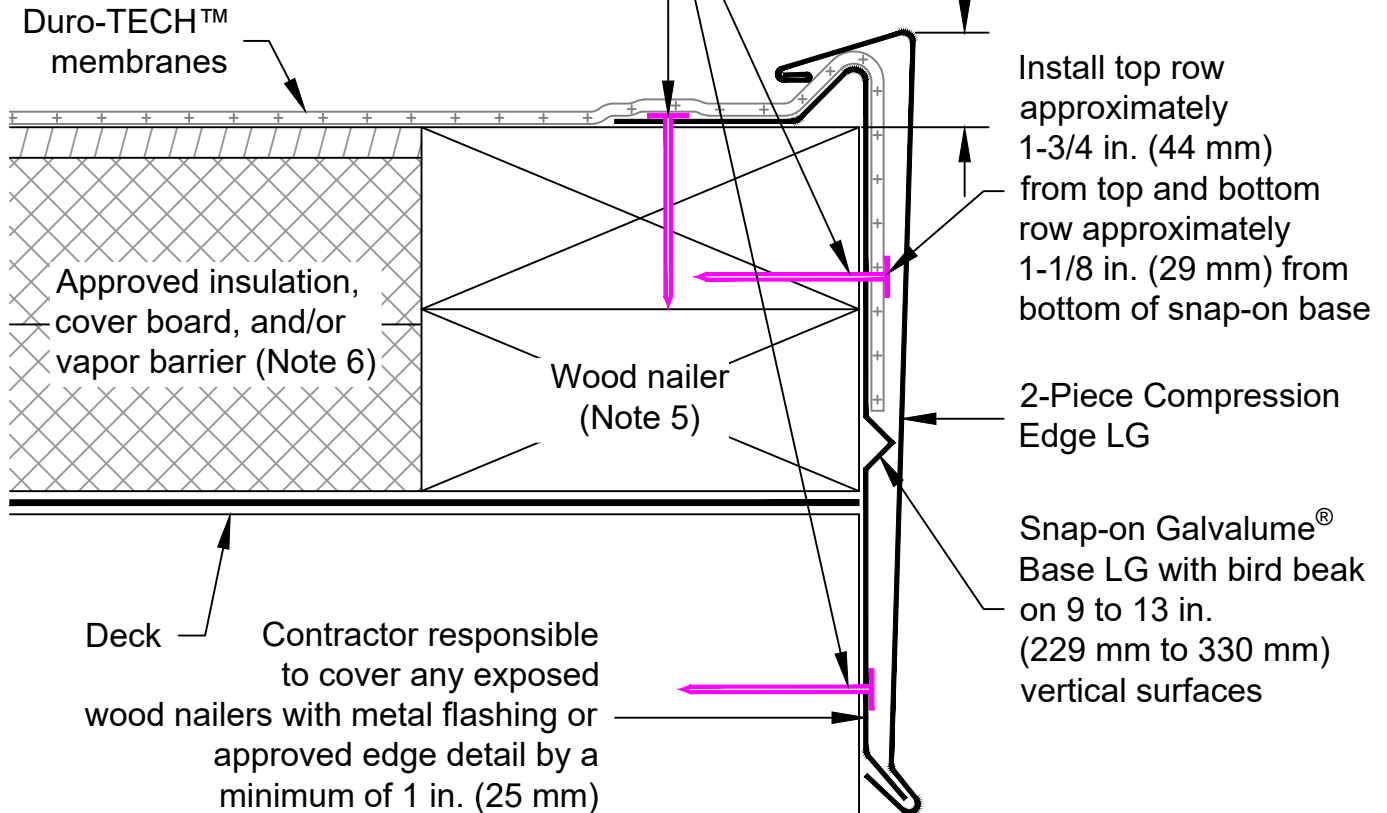

Note 1: This detail is limited to membrane thickness of 45 mils. For membrane greater than 45 mils refer to detail T3116.

Note 2: This detail may also be used on parapet walls.

Note 3: This detail is NOT FOR USE where drainage runs off the building.

Note 4: Allow for 1/8 in. (3 mm) expansion gap between 10 ft (3 m) lengths of snap-on base. Overlap snap-on covers by 2 in. (51 mm) between 10 ft (3 m) lengths.

Note 5: Refer to General Requirements for wood nailer requirements.

Note 6: Refer to specifications for vapor barrier, insulation, and cover board requirements.

REVISED: N/A	TPO EDGE DETAIL FOR MECHANICALLY FASTENED SYSTEMS
PREVIOUS: 10/17/2025	UNIVERSAL 2-PIECE COMPRESSION EDGE LG
SCALE: NONE	NEW CONSTRUCTION OR RE-ROOF