

Option 1

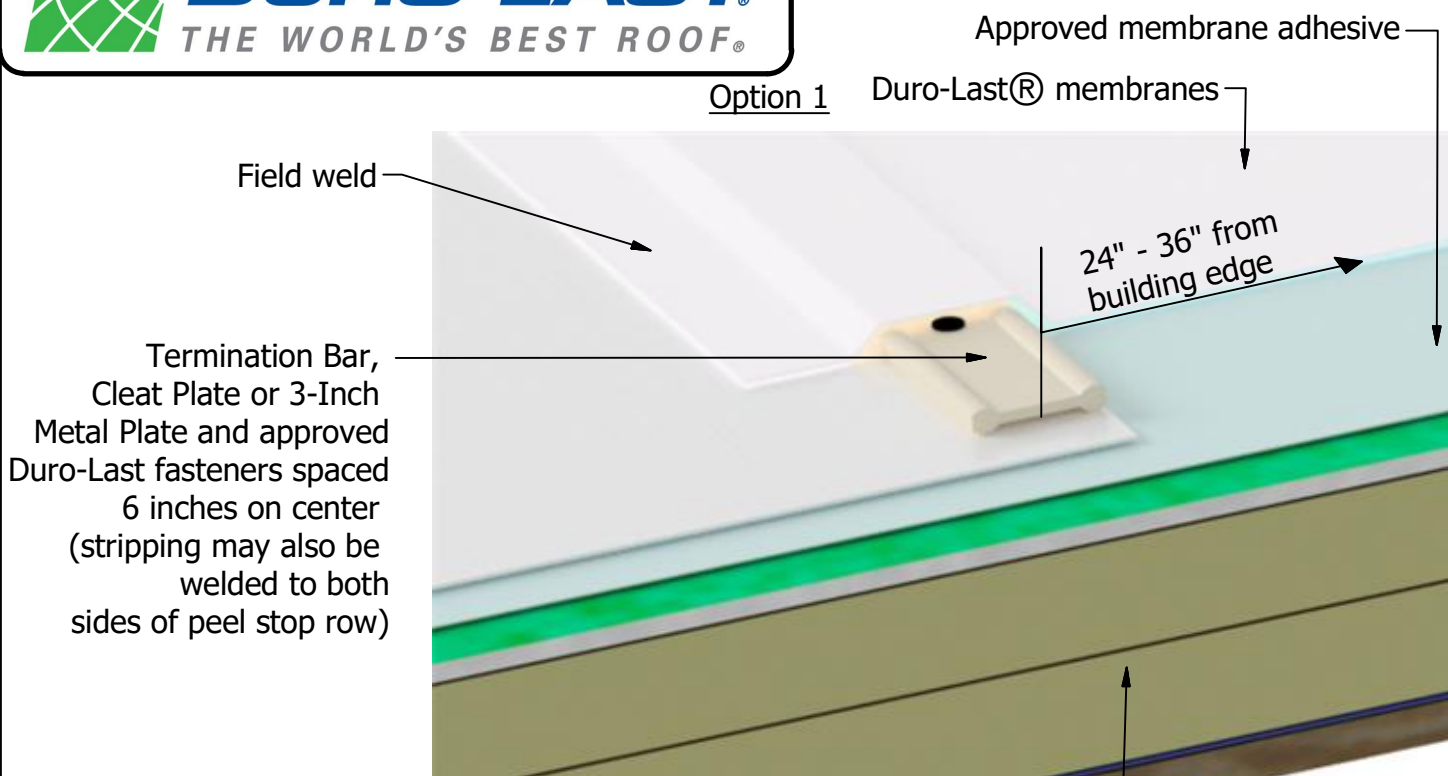

Option 2

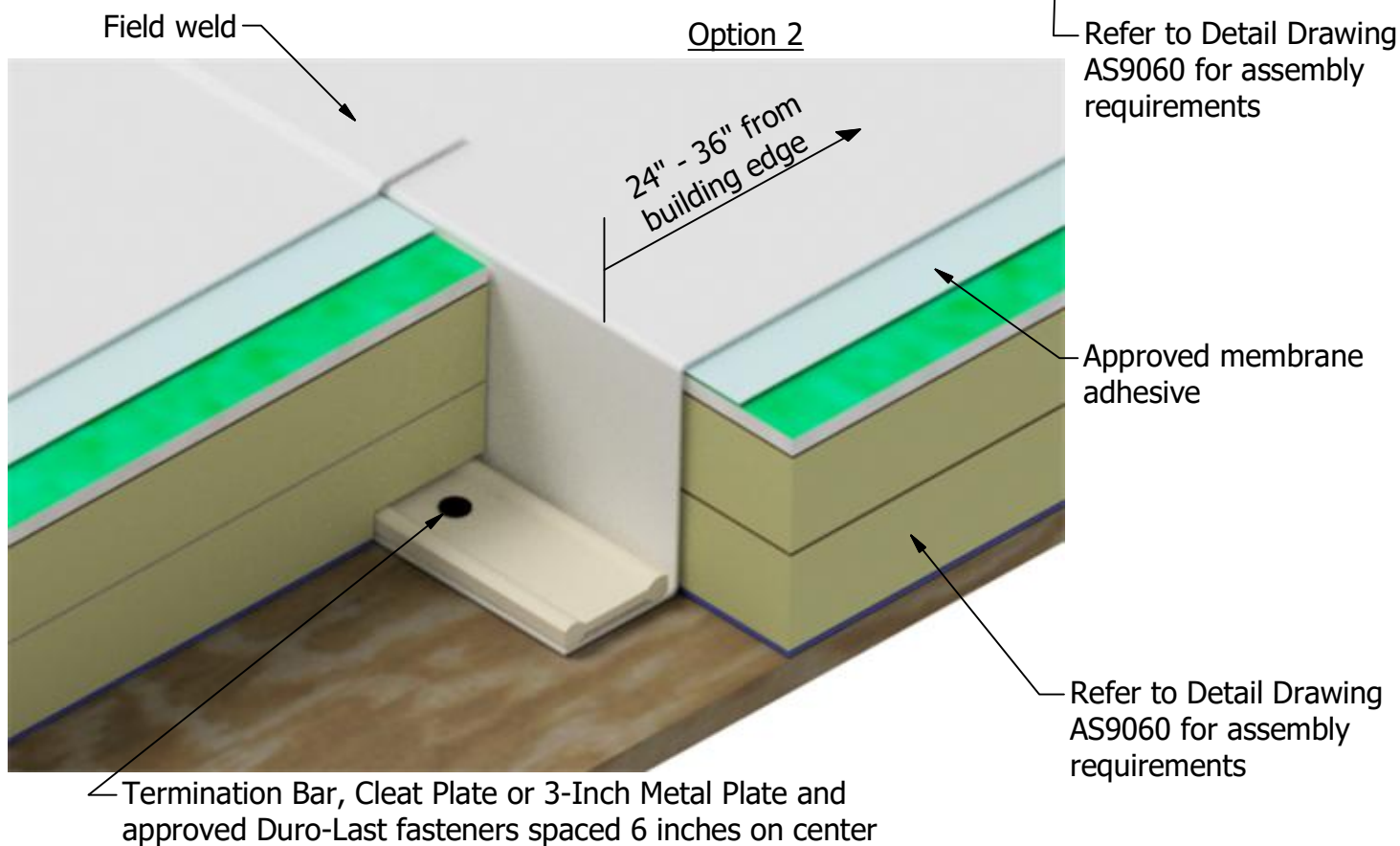

Note: Refer to Detail Drawing AS9060 for peel stop requirements.

REVISED:	12/1/17	INSULATION DETAIL FOR ADHERED SYSTEMS
PREVIOUS:	08/07/17	PEEL STOP INSTALLATION
SCALE:	NONE	NEW CONSTRUCTION OR RE-ROOF