

Attach butterfly corners to either side of extension, trim as necessary (band, sealant, and support not shown for clarity)

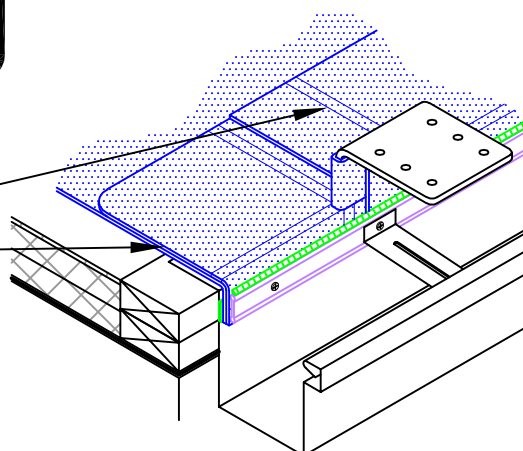

Approved Duro-Last® caulk

Stainless steel band positioned 1/4-inch from top of butterfly corner

Duro-Last membranes

Min. 1 1/2-inch field weld

Ladder Rest bolted to extension with 4 bolts & washers

Butterfly corners

Ladder Rest extension attached to nailer with countersunk screws

Min. 1 1/2-inch field weld

Wood nailer (Note 3)
Approved insulation (Note 4)
Approved cover board (Note 4)

Approved vapor barrier (Note 4)

Approved Duro-Last edge detail (Note 1)

Gutter attached per manufacturer's specifications

Note 1: Appropriate Duro-Last termination must be followed.

Note 2: Wood blocking must be installed below support if insulation is used.

Note 3: Wood nailers must withstand a minimum force of 180 pounds per lineal foot (per building code). Any pull values greater than 270 pounds will allow for a fastener spacing of 18 inches on center. Pull values less than 270 pounds will require additional fasteners. **The installing contractor is responsible for meeting building codes.**

Note 4: Refer to specifications for vapor barrier, insulation and cover board requirements.

REVISED: 07/05/2023

ROOF PENETRATION DETAIL FOR MECHANICALLY FASTENED SYSTEMS

PREVIOUS: 01/28/2017

LADDER REST EXTENSION

SCALE: NONE

NEW CONSTRUCTION OR RE-ROOF