

Hook top of cover on base  
and press downward on  
top face to snap in place

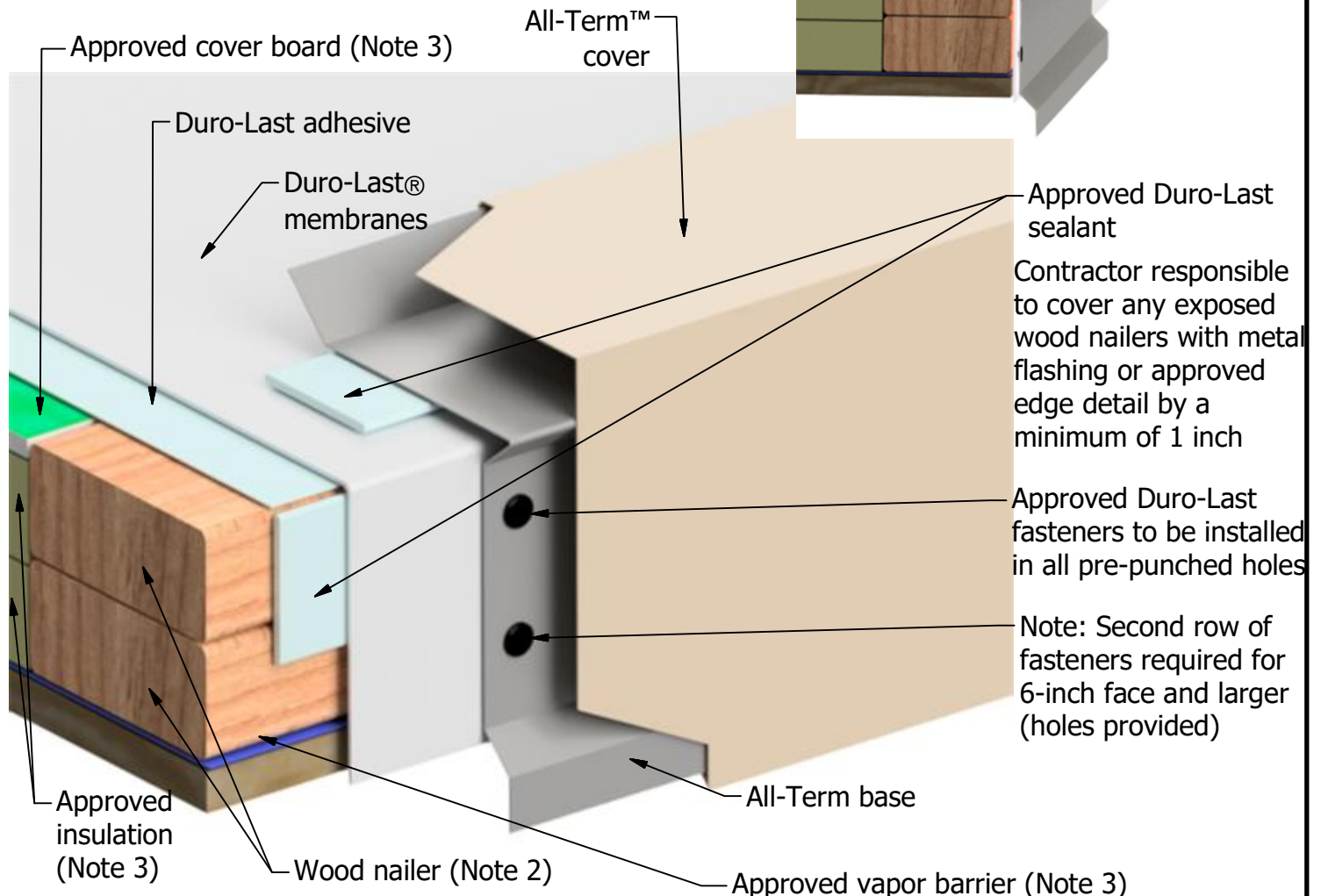

Note 1: Overlap each 10-foot length of base by 1-inch. Overlap the covers by 1 1/2-inches utilizing the pre-notched end on 10-foot lengths.

Note 2: Wood nailers must withstand a minimum force of 180 pounds per lineal foot (per building code). Any pull values greater than 270 pounds will allow for a fastener spacing of 18 inches on center. Pull values less than 270 pounds will require additional fasteners. **The installing contractor is responsible for meeting building codes.**

Note 3: Refer to specifications for vapor barrier, insulation, and cover board requirements

Note 4: This detail may also be used with the Duro-Fleece® roofing systems.

REVISED:	06/06/18	EDGE DETAIL FOR ADHERED SYSTEMS
PREVIOUS:	12/01/17	3" - 13" ALL-TERM™
SCALE:	NONE	NEW CONSTRUCTION OR RE-ROOF