

Utilize Detail TAS4010 with 3/4 in. (19 mm) #14 self-tapping fasteners (by others) approved by FM 4470 testing (Note 2)

Fasten skylight flange with 1-1/4 in. (32 mm) roofing nails spaced 6 in. (152 mm) O.C.

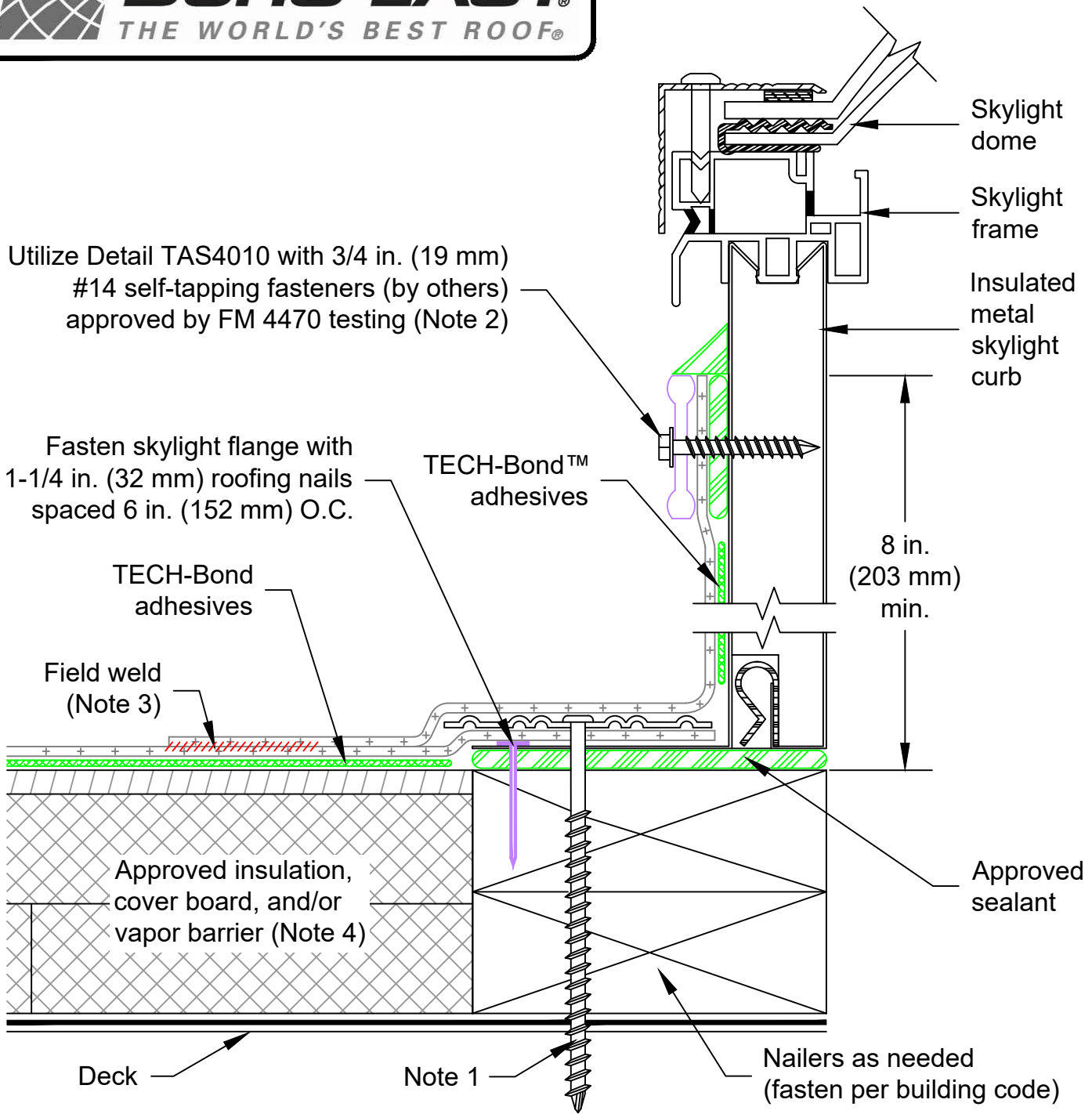

Skylight dome

Skylight frame

Insulated metal skylight curb

8 in. (203 mm) min.

TECH-Bond adhesives

Field weld (Note 3)

Approved insulation, cover board, and/or vapor barrier (Note 4)

Approved sealant

Deck

Note 1

Nailers as needed (fasten per building code)

Note 1: Deck membrane shall be fastened around perimeter of roof penetration as per respective zone the skylight is located within (field, perimeter, corner).

Note 2: Termination Bar must have an approved fastener within 1 in. (25 mm) of each corner.

Note 3: All field welds must be a minimum of 1-1/2 in. (40 mm) wide.

Note 4: Refer to specifications for vapor barrier, insulation, and cover board requirements.

REVISED: N/A

TPO ROOF PENETRATION DETAIL FOR ADHERED NON FLEECE SYSTEMS

PREVIOUS: 05/05/2026

SKYLIGHT DECK MOUNT PENETRATION

SCALE: NONE

NEW CONSTRUCTION OR RE-ROOF