

DETAIL VS1050 MUST BE USED IN CONJUNCTION WITH DETAIL VS1060. REFER TO DETAILS VS1010, VS1020, VS1030, AND VS1040 FOR COMPLETE INSTALLATION.

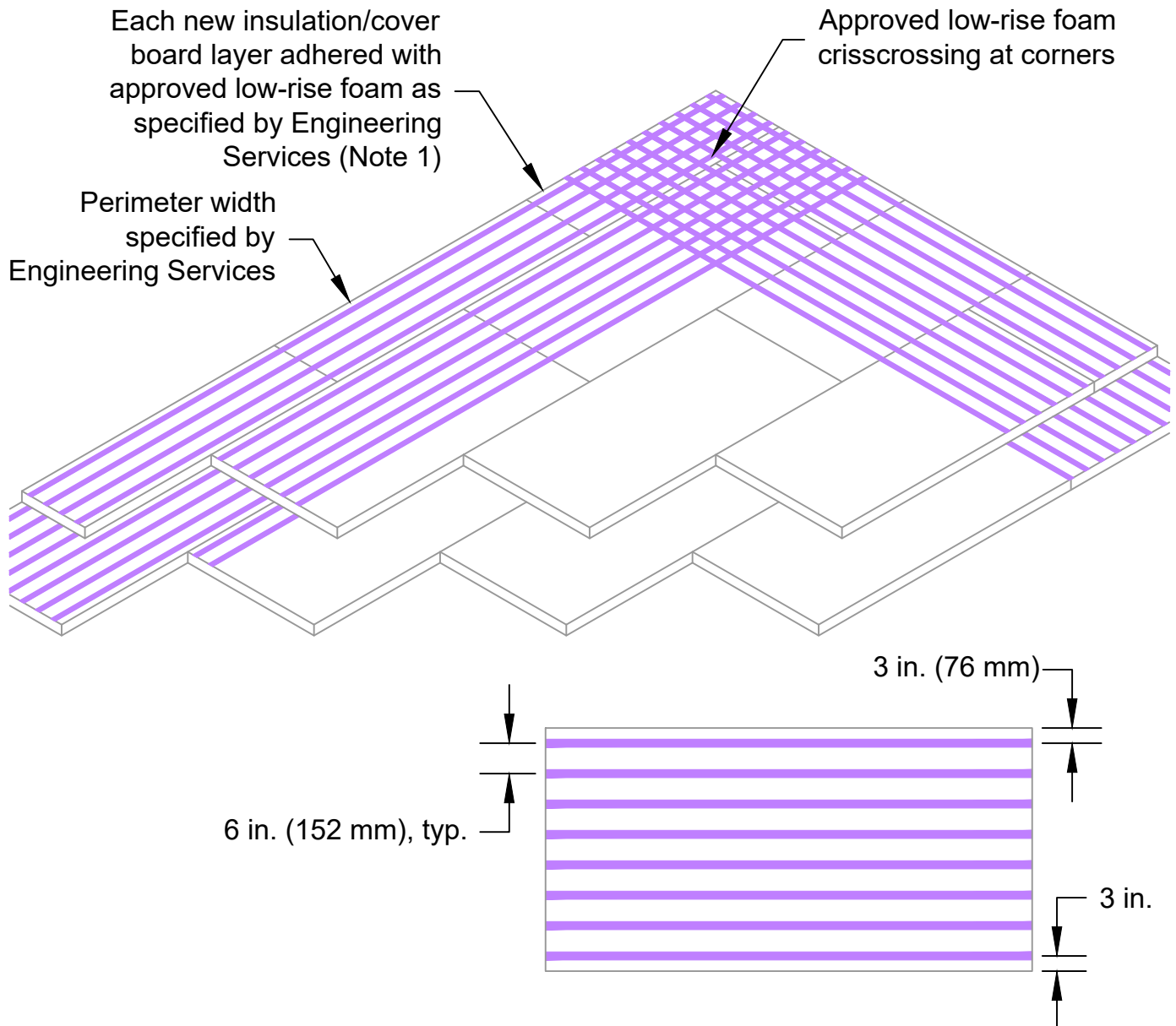

Note 1: Insulation/cover board must be no greater than 4 x 8 ft (1.2 x 2.4 m).

Note 2: It is recommended to stagger all joints between boards by 50% from row to row and layer to layer.

Note 3: Adjoin panel edges together. Neatly fit to roof deck and around penetrations with no gaps greater than 1/4 in. (6 mm). Seal all penetrations and deck/wall transitions.

ALL VADA PROJECTS MUST BE DESIGNED BY ENGINEERING SERVICES

REVISED: N/A	GENERAL DETAIL FOR VADA VENTED ROOF SYSTEMS
PREVIOUS: 01/19/2026	INSULATION/COVER BOARD - PERIMETER ADHESION
SCALE: NONE	NEW CONSTRUCTION OR RE-ROOF