

# HIGH PROFILE® FASCIA

## DESCRIPTION:

The High Profile® (HP) Fascia system features an elevated profile to contain water and/or ballast. It is quick and easy to install with a crimping attachment for unmatched securement.

- Only compatible with 40 mil. single-ply membrane material.
- Water dam and fascia are fabricated in 10' lengths; 4 1/2" through 8" widths.
- Pre-punched fastening holes in the Galvalume® water dam ensure correct fastener placement and spacing.
- Ready-to-assemble inside and outside corners are available.
- LEED® compliant.
- ANSI/SPRI ES-1 compliant.



## INSTALLATION:

1. A wood nailer is required if 1" or greater of insulation is used.
2. Nailer should be attached to the wall in accordance with ANSI/SPRI ES-1.
3. Install in accordance with Duro-Last Detail #3110.
4. Any deviation from the requirements set forth in detail drawings must be pre-approved, in writing, by the Duro-Last Technical Department.

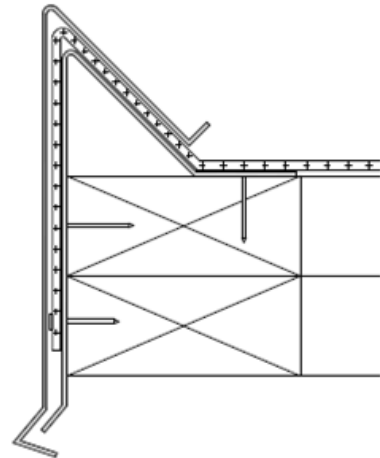

## WARRANTY:

Duro-Last offers a finish and substrate warranty.

Material	Gauge	Finish
Stainless Steel	24-gauge	N/A
Bonderized Steel	24-gauge	N/A
Galvalume®	24-gauge	Mill or Kynar®