

DURO-TECH TPO TWO-WAY AIR VENT

DESCRIPTION:

Duro-TECH TPO Two-Way Air Vents ("Vents") are made to help alleviate air pressure and relieve condensation that is directly underneath a mechanically fastened Duro-TECH™ thermoplastic polyolefin ("TPO") membrane.

The Vents are fabricated from a rigid TPO and have an 18-inch (457-mm) reinforced TPO membrane skirt attached.

ORDERING:

Vents can be ordered individually.

- White (Item #13303TW)
- Tan (Item #13303TB)
- Gray (Item #13303TG)

STORAGE AND HANDLING:

- Keep away from ignition sources.
- Always store in a dry location, protected from the elements.

PRECAUTIONS:

- Keep away from ignition sources.
- Wear proper personal protective equipment, such as gloves and eye protection, per the Safety Data Sheet.

INSTALLATION:

Installation must be completed in compliance with the appropriate Duro-TECH TPO details and specifications.

1. Requirements

- Vents must NOT be used on refrigerated buildings, freezer buildings, or with adhered roofing systems.**
- Vents are not required on open-air structures (e.g. carports) or roofing systems with overburden (e.g. ballast, paver, vegetation, etc.).

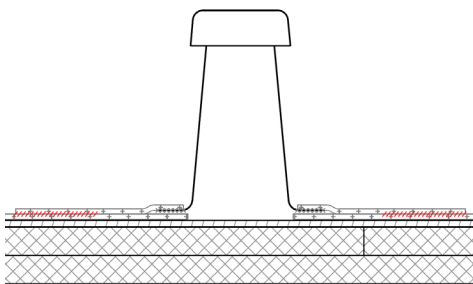

- Install Vents between fastener rows and at high points of roof area.
 - Do **not** install within 7 feet (2.1 m) of the building's edge.
 - **Never** install in low or drainage areas.
- A Vent must be installed for every 1,000 square feet (92.9 m²) of roof area, or portion thereof, but with a minimum of 2 Vents per roof.

2. Vent Placement

- Corners** – Vents must first be installed within 8 – 10 feet (2.4 – 3 m) of the outer corners. Install Two-Way Air Vents at opposite corners whenever possible.
- Roofing Area** – Starting 8 – 10 feet (2.4 – 3 m) from the building edge, evenly distribute the remaining Vents throughout the remaining roof area, if applicable.

- Cut a 4-1/2-inch (114-mm) diameter hole in the TPO deck membrane.

NOTE: DO NOT FASTEN THE DURO-TECH TPO TWO-WAY AIR VENT TO THE ROOF DECK.

- Prepare all affected surfaces by cleaning with an approved TPO cleaner, if necessary.
- Heat (hot-air) weld the Vent's attached skirt to the TPO deck membrane with a minimum 1-1/2-inch (40-mm) weld.