

OPTION #1

OPTION #2

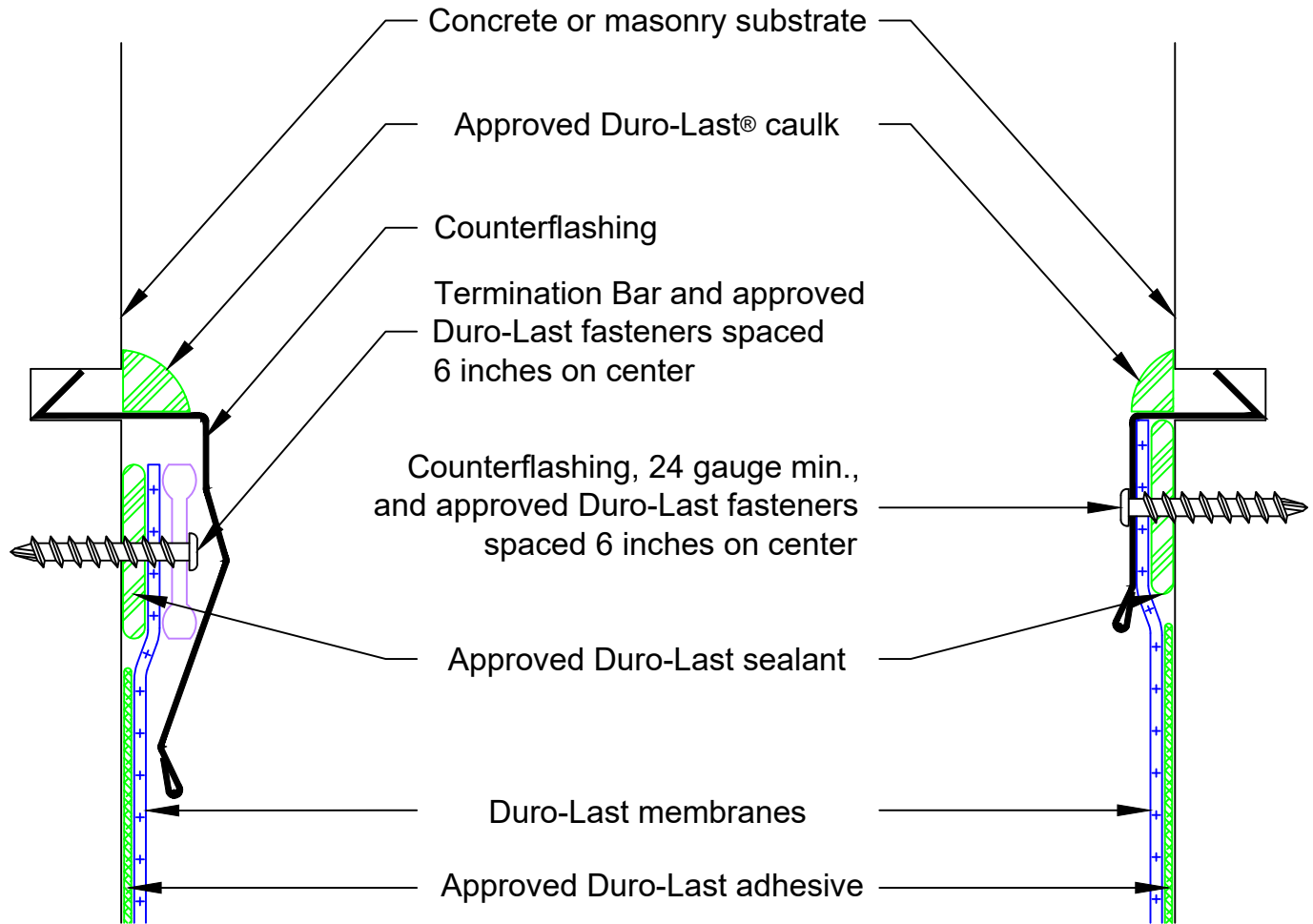

Note 1: This detail is only applicable with concrete or masonry walls.

Note 2: Minimum termination height for parapet wall flashing is 8 inches above finished deck. Refer to Detail Drawing 6020.

REVISED: N/A	PARAPET WALL DETAIL FOR ADHERED NON-FLEECE SYSTEMS
PREVIOUS: 10/24/2022	REGLET COUNTERFLASHING - OPTIONS 1 AND 2
SCALE: NONE	NEW CONSTRUCTION OR RE-ROOF